

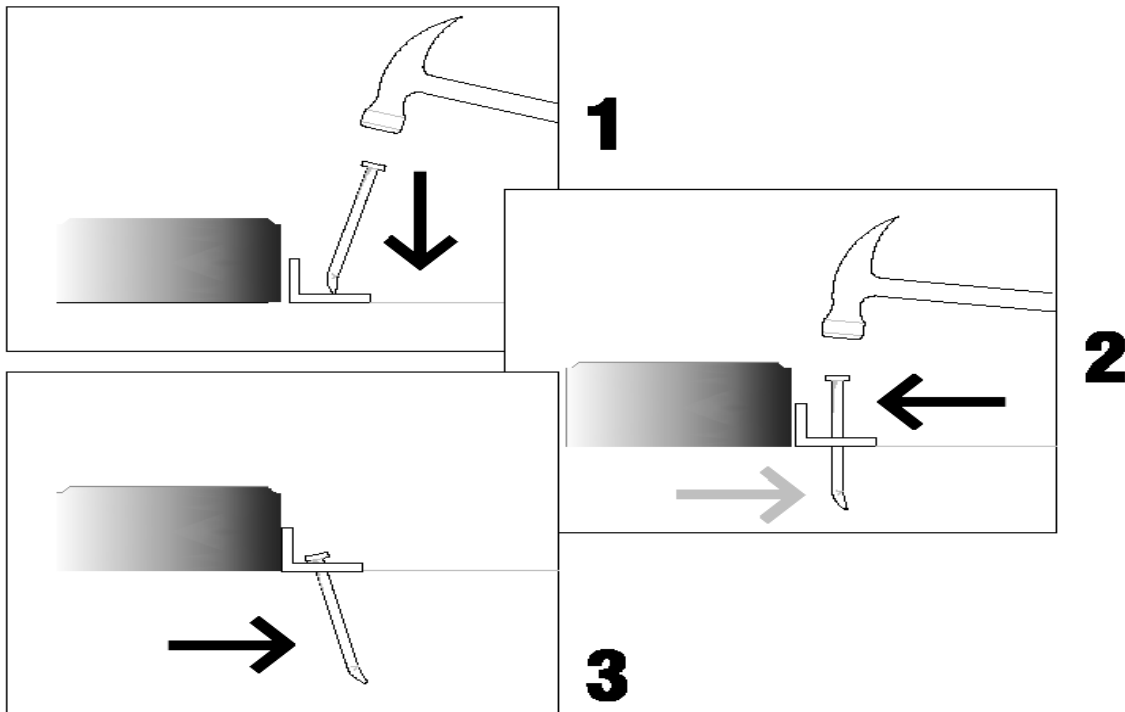

---

### **EdgeTite Fastener Benefits:**

- ✓ Angled install strengthens entire system.
- ✓ Pins edging to brick and base.
- ✓ Helps resist movement from frost heave.



### **How to Install:**

- 1 - Face EdgeTite Fastener angle at tip away from field of work and begin to set fastener with hammer.
- 2 – Continue to hammer in EdgeTite Fastener similar to standard edging fastener and allow head to pitch toward brick edging and field.
- 3 - Final position of EdgeTite Fastener applies constant pressure to brick edging and field.

### **Product Data**

- 160 fasteners per box
- Weight per box 27 LBS.